



GREATER
TACOMA
CONVENTION
CENTER



A walkable downtown destination with a thriving arts and culture scene, Tacoma offers a metropolitan setting surrounded by natural Northwest beauty.

THE **GREATER** WAY FORWARD



A GREATER WAY FORWARD

Our commitment to the health and safety of our employees, partners, clients, exhibitors, and attendees remains our top priority. We have created customized capacity floor plans that address occupancy limits to fit your needs and a flexible booking policy to allow peace of mind when scheduling your next event.

Cleaning & Sanitation

Global Biorisk Advisory Council (GBAC) Star Accreditation. GBAC Star Certification is the cleaning industry's only outbreak prevention, response and recovery accreditation for facilities. Additional cleaning and sanitation enhancements include HVAC upgrades to improve indoor air quality with BiPolar ionization units, electrostatic sprayers to thoroughly disinfect between meetings, and UVC cleaning technology added to escalators. Frequent cleaning and sanitation of high touch and high traffic areas will occur during events.

Physical Distancing

Physical distancing protocols are established, including working with clients on adapted seating arrangements in meeting spaces. Event managers will work with you on modified floor plans.

Guest Amenities

Hand sanitizer will be available at locations throughout the venue. All restroom facility fixtures are touchless and air hand dryers disabled. Water fountains replaced by single bottle fillers in public lobby areas.

Signage

Clear signage in both front and back of house will reinforce COVID-19 policies enforced by staff. Front of house signage will be placed in public common areas such as lobbies, elevators, and at entryways.

Event Modifications

Staggered event times will be utilized if there are multiple events in the facility. Attendees are pre-registered and contact information is retained by event planners.

Food Service

Creative modifications to food service with more pre-packaged individual service items, removal of self-serve buffets and coffee stations, and touchless mobile payment options.

Employee Safety

Employee training and healthy workplace protocols will be implemented, including use of appropriate personal protective equipment and staff wellness checks.

Flexible Booking Guidelines

With the uncertainty of the phased reopening timelines. We have implemented flexible booking guidelines to reduce worries for events in 2021 and beyond.

While things may look a little different, the Greater Tacoma Convention Center's team of experts, breathtaking views, and commitment to safety remain unchanged. Stay healthy and rest assured that we will continue to adapt and be with you on a Greater Way Forward.



Marriott Tacoma Downtown

The 22-story hotel opened in November of 2020.

With locally-inspired accents, the 304-room hotel is adjoined to the Greater Tacoma Convention Center via a grand promenade featuring large windows and views of the Tacoma waterfront and Mt. Rainier. The skybridge from convention center to hotel provides guests social gathering places, amenities like a rooftop swimming pool, a 24-hour business center and more.

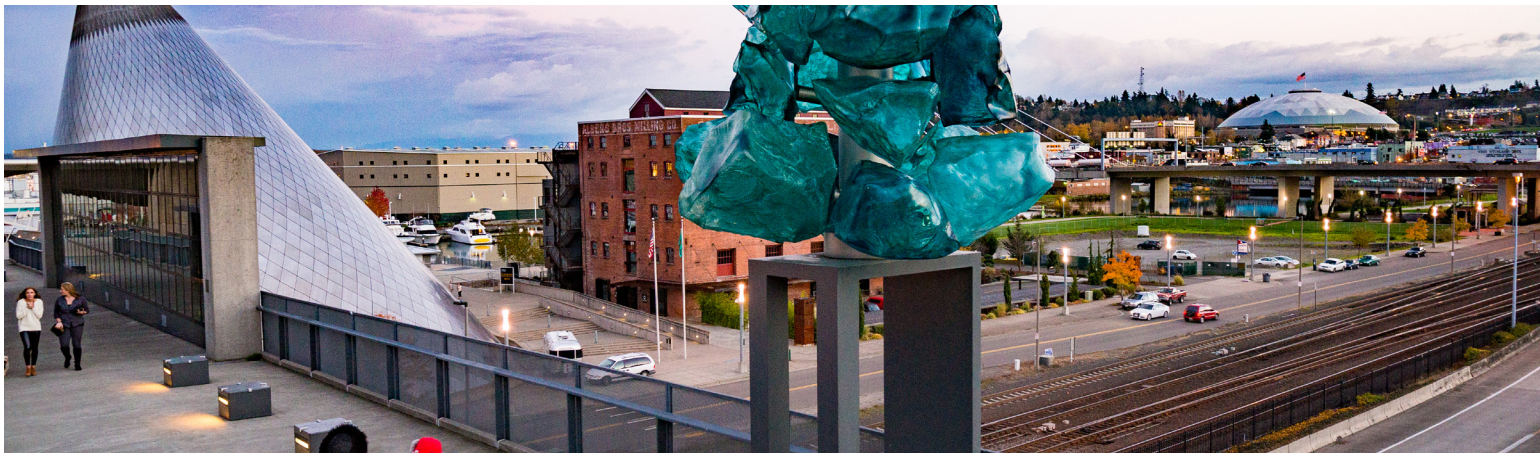



GREATER EXPERIENCE

Central Location

Tacoma is in close proximity to Sea-Tac Airport, Seattle, Olympia, and Mt. Rainier. The Greater Tacoma Convention Center is located just off of I-5 in the heart of downtown Tacoma, 18 miles from the airport.

Accommodations

The facility is adjacent to premium hotels and within close proximity to a wide range of guest room options for citywide conventions, including the connected Marriott Tacoma Downtown. Our staff is available to assist with hotel needs.

Light Rail

The Convention Center light rail stop links Tacoma visitors downtown, in the Theater District, Hilltop, and the Dome District. With easy, on-site

and street parking, we are located in a safe, walkable area.

Citywide Hospitality

Visitors to Tacoma find a welcoming environment, with merchants and information centers eager to accommodate your guests to enjoy everything a genuine Northwest experience has to offer, including cultural attractions, dining, nightlife and the outdoor attractions.

Attention to Detail

Our **team of experts** is dedicated in assisting you through every stage of your event, including catering, audio/visual, ticketing, safety, and marketing services.

Facility Highlights

- Five loading bays, including drive-on ramp to Exhibition Hall

- Built-in registration on the third floor, connects to office/storage area
- Sweeping views of downtown Tacoma and Mt. Rainier
- Robust Wi-Fi access throughout the facility
- Over **24,000** square feet of pre-function space
- Ballroom with **13,650** square feet (divisible up to three rooms)
- Exhibition Hall with **50,000** square feet of column-free space
- Glass-enclosed entries, lobbies, and spectacular suspended stairway
- Seven art installations, including Andy Warhol's famous *Flowers for Tacoma*



Marriott Tacoma Downtown (3rd Floor)

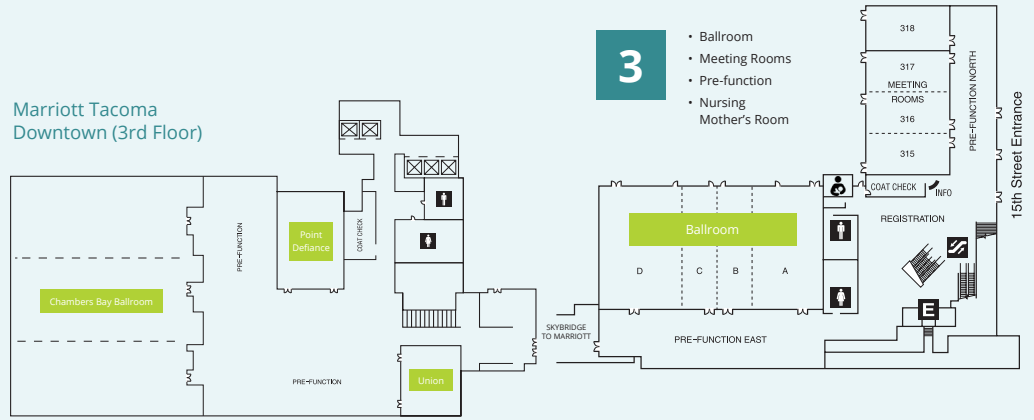

3

- Ballroom
- Meeting Rooms
- Pre-function
- Nursing
- Mother's Room

1

- Administration
- Boardrooms
- Light Rail Train Stop
- Visit Tacoma-Pierce County Office

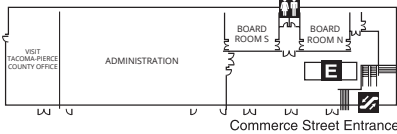

4

- Meeting Rooms

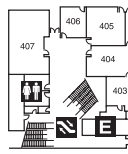

5

- Exhibition Hall
- Pre-function
- Loading Docks

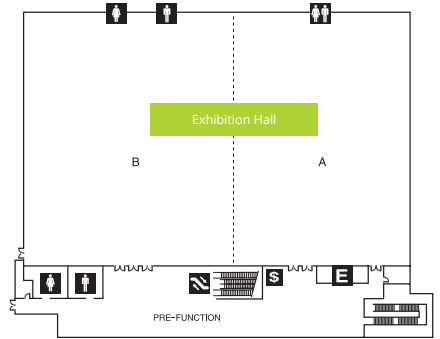

The Greater Tacoma Convention Center is one of **Washington State's largest** meeting and convention facilities. Our well-designed event spaces make our venue one of the most user-friendly facilities in the industry.

ROOM	FLOOR	SQ. FT.	CEILING	L' X W'	THEATER	ROUNDS	CLASSROOM	CONFERENCE	U-SHAPED	10' X 10'
Boardroom North	1	720	8'	30 x 24	—	—	—	18	—	—
Boardroom South	1	792	8'	33 x 24	—	—	—	18	—	—
Ballroom A	3	4400	23' 8"	88 x 50	400	230	230	100	80	20
Ballroom C	3	2200	23' 8"	88 x 25	200	70	95	80	75	9
Ballroom D	3	4575	23' 8"	88 x 52	400	230	230	100	80	20
Ballroom A and B	3	6600	23' 8"	88 x 75	650	360	335	125	95	30
Ballroom B and C	3	4400	23' 8"	88 x 50	400	230	230	100	80	20
Ballroom C and D	3	6775	23' 8"	88 x 77	650	360	335	125	95	30
Ballroom A, B and C	3	8710	23' 8"	88 x 99	800	480	430	150	110	40
Ballroom B, C and D	3	8975	23' 8"	88 x 102	800	480	430	150	110	40
Ballroom A, B, C and D	3	13650	23' 8"	88 x 152	1200	720	675	210	160	60
Ballroom Pre-function Area East	3	6260	30'	--	--	240	200	—	—	20
Meeting Room 315	3	1560	18'	58 x 27	140	80	75	55	50	—
Meeting Room 316	3	1970	18'	58 x 34	170	100	90	60	50	—
Meeting Room 317	3	1560	18'	58 x 27	140	80	75	55	50	—
Meeting Room 315 & 316	3	3530	18'	58 x 61	310	180	165	85	65	—
Meeting Room 316 & 317	3	3530	18'	58 x 61	310	180	165	85	65	—
Meeting Room 315, 316 & 317	3	5100	18'	58 x 88	450	240	240	110	90	15
Meeting Room 318	3	1740	18'	58 x 30	140	80	75	55	50	—
Third Floor Registration Area	3	5660	14'	—	—	—	—	—	—	10
Third Floor North Pre-function	3	3510	32'	—	—	—	—	—	—	10
Meeting Room 403	4	418	12'	22 x 19	30	20	20	20	16	—
Meeting Room 404	4	828	12'	36 x 23	70	32	30	28	22	—
Meeting Room 405	4	900	12'	30 x 30	90	40	40	28	22	—
Meeting Room 406	4	456	12'	24 x 19	40	20	15	22	18	—
Meeting Room 407	4	1470	13' 4"	49 x 30	140	60	60	46	39	—
Exhibition Hall A	5	22200	30'	182 x 122	1900	980	1230	—	—	120
Exhibition Hall B	5	27300	30'	182 x 150	2200	1260	1560	—	—	150
Exhibition Hall A and B	5	50000	30'	182 x 272	4250	2520	2900	—	—	270
Exhibition Hall Pre-function Area	5	8780	15'	218 x 46	—	360	—	—	—	20